

CERTIFIED RECORD OF LAND CORNER MONUMENTATION

Index File No. Q-R-9

History of original corner establishment:

None.

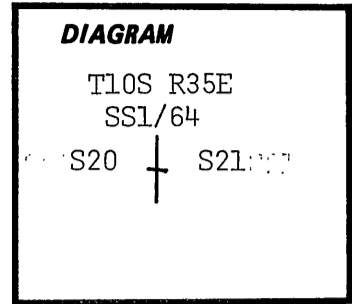

Description of corner evidence found:

None.

Corner falls on north edge of drain inside of fence corner.

Description of monument and accessories I established to perpetuate the original location of this corner:

T10S R35E
SS1/64
S20 + S21
OR PLS 1051
1980

At surveyed point set 2 1/2" X 30" galvanized pipe and brass cap marked: Set pipe 24" in the ground and mound of stone around to cap. From which by magnetic declination of N20°E: A 15" fir bears N16°E, 41.4 ft. scribed SS1/64S20 BT. An 18" pine bears S03°W, 81.7 ft. scribed SS1/64S21 BT. Painted blazes red and 6" red band around. Placed 54-3s, 54-9s and brass washers stamped PLS 1051 on BTs. Placed 54-2 and 54-9 on steel fence post 5' north and 54-9 on steel fence post 5' east of the corner.

I hereby certify that the above corner monument was reestablished as herein described.

Witnesses: Daniel Rowland
Larry Shirley

August 28, 1980

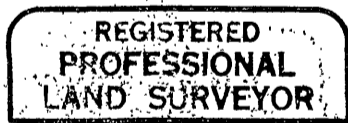

Barry B. Barbour

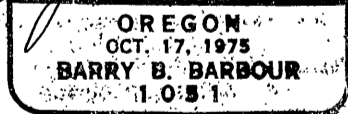

Office of..... County Surveyor..... County of... Grant
Oregon
State of....., I hereby certify that the within instrument was filed in this office
for record on the 20th 23 day of January, 1981
Robert D. Buzitt by
(COUNTY OFFICIAL) (DEPUTY)