

CERTIFIED RECORD OF LAND CORNER MONUMENTATION

History of original corner establishment:

*Original corner established in 1901 by George Campbell.
Set stone 18x14x10 marked 1/4 on W face.*

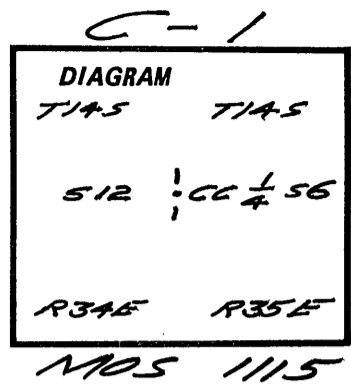

Description of corner evidence found:

21x12x11 stone marked 1/4 on N face. Stone lying horizontal on ground. Section line runs 0.26' west of center of found stone and I therefore buried said stone alongside monument set,

Description of monument and accessories I established to perpetuate the original location of this corner:

Cap marked

Set 2 1/2" x 30" aluminum pipe with 2 1/2" aluminum cap rising 4" in stone mound.

T145 R35E

References:

5/8" x 30" iron rod with 1 1/2" aluminum cap mkd. RP W 1/8 . 56 1989 LS1020

1/4 56 CC
1989
LS1020

Aluminum capped aluminum pipe in stone mound brs. N00°17'33"W 175.81'

Cap mkd. T135 R34E
CC 51 1/4
1989
LS1020

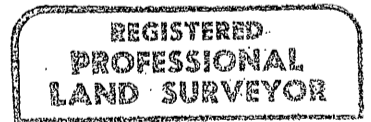

George W. Colvin, Jr.

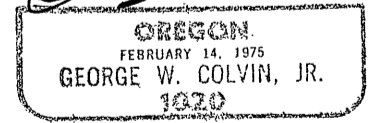

I hereby certify the above corner was established as described in June, 1989.

Office of Grant Co. Surveyor County of Grant
State of Oregon, I hereby certify that the within instrument was filed in this office for record on the 9 day of Nov, 1989
Robert D. Baggett by _____
(COUNTY OFFICIAL) (DEPUTY)