

- P. Pine 36" dia. bears N87°23'E 65.7 feet  
(record N89°E 65.2 feet).
- P. Pine 14" dia. bears N86°40'W 27.9 feet  
(record N86°W 27.8 feet).
- P. Pine snag 24" dia. bears N67°01'W 32.9 feet  
(record N67°W 31.0 feet).

Center 1/4 Corner Section 25: I set a 2" x 30" galvanized iron pipe with a 2-1/2" brass cap 12 inches below the surface of Forest Service Road No. 3974, from which:

I mark the following trees, taking measurements to the center of tree at the lower blaze in which I place a brass washer marked L.S. 1679:

- D. Fir 11" dia. bears S0°48'W 43.9 feet.
- D. Fir 16" dia. bears S74°50'W 85.1 feet.

Bearing was based on a solar observation.

Surveyed by: T. Flatebo and Associates, Inc.  
P.O. Box 900  
Jacksonville, OR 97530

Date: Survey began October 21, 1980.  
Completed January 30, 1981.

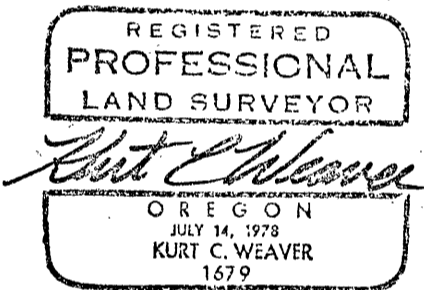

RECEIVED AND  
FILED

MAR 4 1981

OFFICE OF COUNTY SURVEYOR

Attest: *Annice Lawrence*