

MOS # 674

NE 1/16 corner Section 2 : Set a 2" x 30" flanged G.I. pipe with a 2-1/2" brass cap exposed 6" from which I mark the following trees as required, taking measurements to the center of the tree at the lower blaze in which I place a brass washer marked LS 1679:

D. Fir 9" dia. bears S38°22'W 36.6 feet  
Tamarack 8" dia. bears N45°57'W 11.4 feet

CN 1/16 Section 2 : Set a 2" x 30" flanged G.I. pipe with a 2-1/2" brass cap exposed 8" from which I take the following references:

Set a 5/8" x 30" iron pin with a yellow plastic cap marked LS 1679 bears N89°30'E 30.97 feet.

Set a 5/8" x 30" iron pin with a yellow plastic cap marked LS 1679 bears S3°18'W 33.97 feet.

NW 1/16 corner Section 2 : Set a 2" x 30" flanged G.I. pipe with a 2-1/2" brass cap exposed 8" in a mound of stone from which I mark the following trees as required, taking measurements to the center of the tree at the lower blaze in which I place a brass washer marked LS 1679:

P. Pine 12" dia. bears N42°40'E 39.3 feet  
P. Pine 11" dia. bears N34°40'W 36.9 feet

CW 1/16 corner Section 2 : Set a 2" x 30" flanged G.I. pipe with a 2-1/2" brass cap exposed 8" in a mound of stone from which I mark the following trees as required, taking measurements to the center of the tree at the lower blaze in which I place a brass washer marked LS 1679:

L.P. Pine 8" dia. bears N43°36'E 23.0 feet  
L.P. Pine 6" dia. bears N87°34'W 21.5 feet

SW 1/16 corner Section 2 : Set a 2" x 30" flanged G.I. pipe with a 2-1/2" brass cap exposed 1" from which I mark the following trees as required, taking measurements to the center of the tree at the lower blaze in which I place a brass washer marked LS 1679:

Tamarack 8" dia. bears N84°29'E 28.3 feet  
Tamarack 8" dia. bears N25°46'W 33.8 feet

CS 1/16 corner Section 2 : Set a 2" x 30" flanged G.I. pipe with a 2-1/2" brass cap exposed 8" from which I mark the following trees as required, taking measurements to the center of the tree at the lower blaze in which I place a brass washer marked LS 1679:

Fir 10" dia. bears S43°45'E 3.0 feet  
Tamarack 8" dia. bears S69°01'W 7.2 feet

Bearing was based on a solar observation.

Surveyed By: T. Flatebo and Associates, Inc.  
P.O. Box 900  
Jacksonville, OR 97530

Date: Survey began January 12, 1981.  
Completed March 31, 1981.

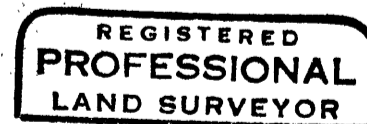

*Kurt C. Weaver*

