

CERTIFIED RECORD OF LAND CORNER MONUMENTATION

X-1

History of original corner establishment:

F.W. Campbell under G.L.O. Contract No.380, dated Mar. 19, 1881, set a pine post from which:

- A Fir, 6" dia., N40°E, 8 lks.
- A Fir, 4" dia., S70°W, 218 lks.

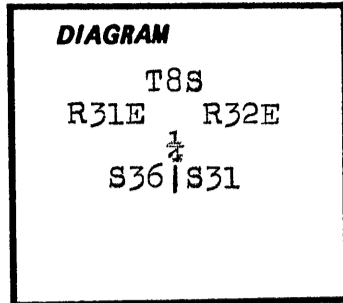

Description of corner evidence found:

None.

Description of monument and accessories I established to perpetuate the original location of this corner:

At the corner point, established by proportionate measurement, I set a 2 1/2" x 30" alum. pipe with a 2 1/2" alum. cap marked: Monument is 22" in the ground and surrounded by a mound of stone. From the corner:

- A Ponderosa Pine, 13" dia., S21 1/4°W, 27.8 ft.; marked: 1/4 S36 BT
- A Ponderosa Pine, 20" dia., S25°E, 37.2 ft.; marked: 1/4 S31 BT
- A Douglas Fir, 16" dia., N73 1/4°E, 52.3 ft.; marked: 1/4 S31 BT
- A Ponderosa Pine, 35" dia., N34°E, 51.2 ft.; marked: 1/4 S31 BT

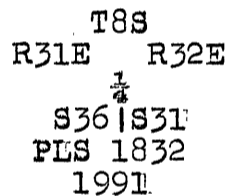

BTs have blaze and a 6" band painted red, BT tags, "Land Survey Monument" signs and alum. "PLS 1832" washers nailed to the bottom of the blaze. There is a 6' steel fence post with a "Land Survey Monument" sign within 5' of the corner..

Measured to center of BTs using steel tape and staff compass. Magnetic declination set at 19°E..

May 24, 1991

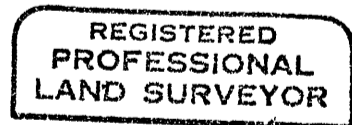

Fayette S. Munro

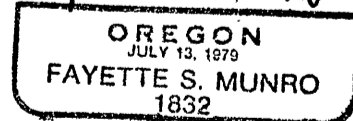

Office of Surveyor County of Grant
 State of Ore gon, I hereby certify that the within instrument was filed in this office
 for record on the 12 day of Nov, 1991
Grant D. Dwyer by _____
 (COUNTY OFFICIAL) (DEPUTY)

See Map # 1192

X-1