

TOWNSHIP 13 SOUTH, RANGE 31 EAST, OF THE WILLAMETTE MERIDIAN, OREGON
 CORRECTIVE DEPENDENT RESURVEY

Sec. 26

Sec. 25

Sec. 35

Sec. 36

A history of surveys is contained in the field notes.

This plat represents a corrective dependent resurvey of the north one-half mile between sections 35 and 36, T. 13 S., R. 31 E., Willamette Meridian, Oregon, designed to restore the corners in their true original locations according to the best available evidence.

The survey was executed by Rick E. Tawney, Cadastral Surveyor, beginning January 25, 1989, and completed January 26, 1989, pursuant to Special Instructions dated January 13, 1989, under Group Number 1473, Oregon.

Timber in this area consists of juniper.

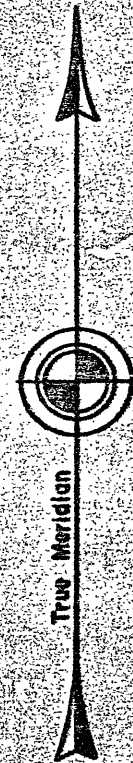

Latitude 44° 23.8' N
 Longitude 118° 56.4' W
 (NAD 1927)

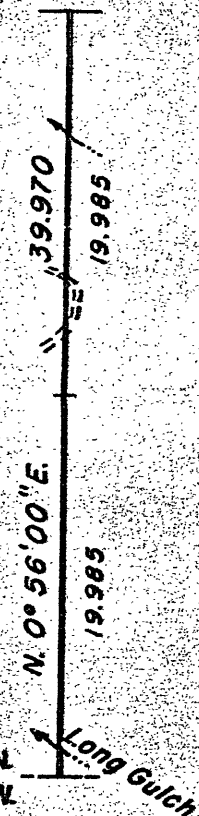

UNITED STATES DEPARTMENT OF THE INTERIOR
BUREAU OF LAND MANAGEMENT

Portland, Oregon May 12, 1989

This plat is strictly conformable to the approved field notes, and the survey, having been correctly executed in accordance with the requirements of law and the regulations of this Bureau, is hereby accepted.

For the Director

Wayne M. Henderson
 Chief Cadastral Surveyor of Oregon

RECEIVED AND FILED

OCT 5 1989

OFFICE OF COUNTY SURVEYOR
 Attest: *[Signature]*