

BASIS OF BEARINGS
 LAND PARTITION PLAT NO. 2009-04
 AS SHOWN

NARRATIVE

THIS SURVEY WAS PREPARED AT THE REQUEST OF DENNIS SHULZE, OWNER OF THE LAND DESCRIBED IN DEED INSTRUMENT NO.'S 20082955, 20090417 AND 20090498, DEED RECORDS OF GRANT COUNTY, OREGON. THE PURPOSE OF THIS SURVEY WAS TO SET IRON PINS AT THE NORTHEAST AND NORTHWEST CORNERS OF MR. SHULZE'S PROPERTY.

A SEARCH WAS MADE OF AVAILABLE RECORDS. I FOUND LAND PARTITION PLAT NO. 2009-04 WHICH WAS PREPARED BY JASON HATFIELD, PLS IN MARCH 2009. I ALSO FOUND RECORD SURVEY NO. 442 WHICH WAS PREPARED BY ROBERT BAGETT, PLS IN 1977.

PINS SET OR FOUND DURING THE SURVEY FOR LAND PARTITION PLAT NO. 2009-04 CONTROLLED THE BOUNDARY FOR THIS SURVEY. I FOUND THE NORTHEAST CORNER OF PARCEL 1 FROM THE PARTITION DISTURBED, AS SHOWN. THE PIN IS NOT ACCEPTED, AND ALL DIMENSIONS SHOWN HEREON ARE TO THE RECORD CORNER POSITION. ALL OTHER FOUND PINS SHOWN HEREON ARE ACCEPTED.

I DETERMINE THE NORTHWEST CORNER OF MR. SHULZE'S PROPERTY AT DEED RECORD DISTANCE FROM THE FOUND IRON PIN FROM SURVEY NO. 442. THE NORTH LINE OF THE SUBJECT PROPERTY IS PARALLEL TO THE NORTH LINE OF THE CARY AND MARALEE CARR TRACT TO THE NORTH. WE SET THE NORTHEAST CORNER OF THE SUBJECT TRACT ON THE WEST RIGHT OF WAY LINE OF THE UNNAMED STREET AS DESCRIBED IN DEED INSTRUMENT NO. 20090417.

REFERENCES

- RECORD MAP OF SURVEY NO. 442
- LAND PARTITION PLAT NO. 2009-04
- DEED RECORD INSTRUMENT NO.'S 20082955, 20090416, 20090417, 20090418, 20090498 & 20181874
- DEED RECORD BOOK 90, PAGE 510

LEGEND

- FOUND 5/8" IRON PIN WITH ATTACHED YELLOW PLASTIC CAP MARKED BENCHMARK SURVEYING FROM LAND PARTITION NO. 2009-04
- FOUND 5/8" IRON PIN - NO CAP FROM SURVEY NO. 442
- SET 5/8"x30" IRON PIN WITH ATTACHED YELLOW PLASTIC CAP MARKED BENCHMARK SURVEYING
- () DEED RECORD BEARING AND DISTANCE
- [] RECORD BEARING: SURVEY NO. 442
- 1[] RECORD BEARING AND DISTANCE: LAND PARTITION NO. 2009-04
- x-x FENCE LINE

REGISTERED PROFESSIONAL LAND SURVEYOR
 OREGON
 JULY 9, 2002
 MICHAEL C. SPRINGER
 #70918
 EXPIRES: 6/30/2022

RECEIVED AND FILED
 GRANT COUNTY SURVEYOR
 JUL 10 2020
 BY: [Signature]

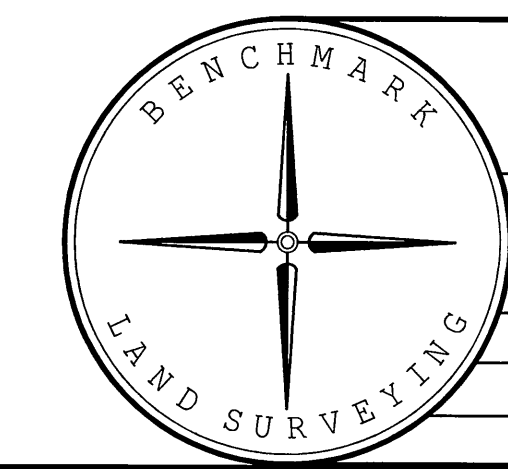

BENCHMARK LAND SURVEYING
 217 N. CANYON BLVD. JOHN DAY, OREGON
 541-575-1251

MAP OF SURVEY
 SITUATED IN THE NW1/4NW1/4 SECTION 11,
 T.13S., R.33E., W.M.,
 CITY OF PRAIRIE CITY, GRANT COUNTY, OREGON

SURVEYED FOR	DENNIS SHULZE	
SURVEYED BY	MCS & NNS	7/7/2020
SCALE: 1"=30'	DRAWN BY: MCS	