

T 13 S R 31 E

S 22 S 23
S 27 S 26

S 89° 43' 44" W 700.00
(N 89° 43' E)
Section line

S 67° 26' 16" E 104.00

Set R.R. Spike

S 86° 49' 16" E 199.00

Set R.R. Spike

N 86° 35' 44" E 203.20

OGILVIE DRIVE

N 0° 13' 00" E 600.00

S 89° 43' 44" W 30.00

(S 0° 10' W)
N 0° 13' 00" E 70.00

(N 89° 43' E)
S 89° 43' 44" W 16.20

(S 7° 59' E)
N 7° 58' 16" W 23.38
(23.5)

(N 40° 05' W)
S 40° 04' 16" E 22.00
(22.15)

LC = N 65° 59' 47" E 138.50
(N 65° 58' E)

A = 36° 02' 23"
R = 282.00
L = 176.04

A = 119° 11' 04"
R = 220.00
L = 103.88

(S 81° 53' 37" W)
N 81° 54' 21" E 5.00
(S 22° 20' W)
N 22° 20' 44" E 15.10

N 3° 20' 14" E 216.50
(S 3° 18' 30" W)

S 89° 31' 04" E 586.56
(N 89° 29' 30" W) (586.2)

S 0° 13' W 415.00
(N 0° 10' E)

Fd. unrecorded 3/4" iron pipe
0.5 ft. N. of cor.

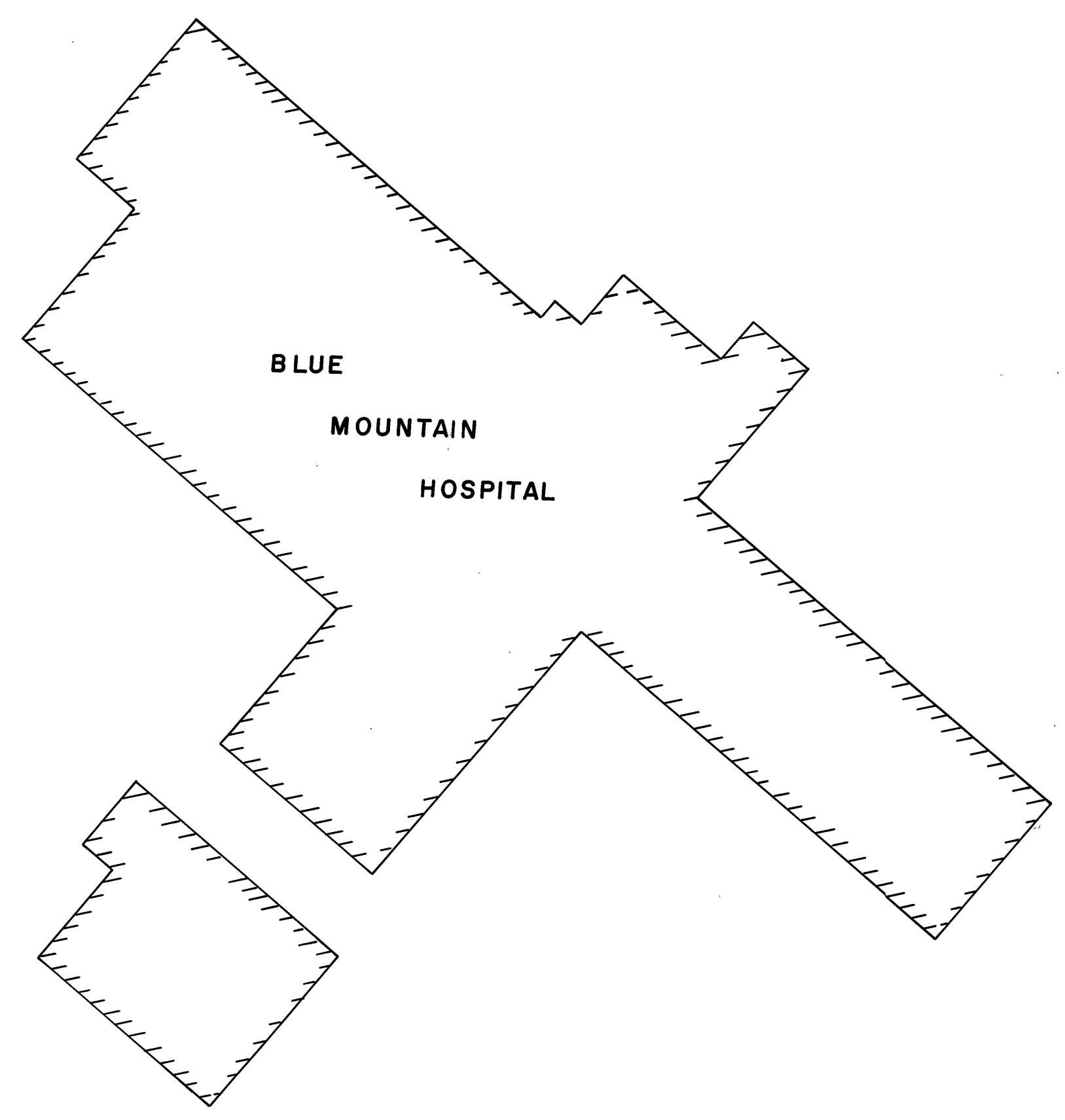

BLUE MOUNTAIN HOSPITAL



BASIS OF BEARINGS
Solar Observation

LEGEND

- ⊙ Found Section Corner (Axle set in concrete)
- Set 5/8" X 30" Iron Pin With Plastic Cap Marked B.G.F. Survey Mark
- Set P.K. Nail
- () Record Bearing & Distance from deeds.

REFERENCE MATERIAL

Book 85 Page 592, & 593
Book 80 Page 83 Deed Records
Filed in the office of the Grant Co. Clerk

REGISTERED
OREGON
LAND SURVEYOR
Robert D. Bagett
JULY 12, 1963
ROBERT D. BAGETT
5 9 8

RECEIVED AND FILED
MAY 13 1971
JOHN L. VEIRA, County Clerk
By: _____ Deputy

BAGETT-GRIFFITH-FERGUSON		
John Day, Oregon		
Map of Survey		
PARCEL OF LAND SITUATED IN THE N. W. 1/4 NW. 1/4 SEC. 26, T13S, R31E, W.M. IN THE CITY OF JOHN DAY GRANT COUNTY, OREGON		
SURVEYED FOR	BLUE MOUNTAIN HOSPITAL	
SURVEYED BY	R. D. B. & D.M.F.	May 1971
Scale: 1" = 30'	Drawn by: D.M.F.	May 1971