

Vicinity Map

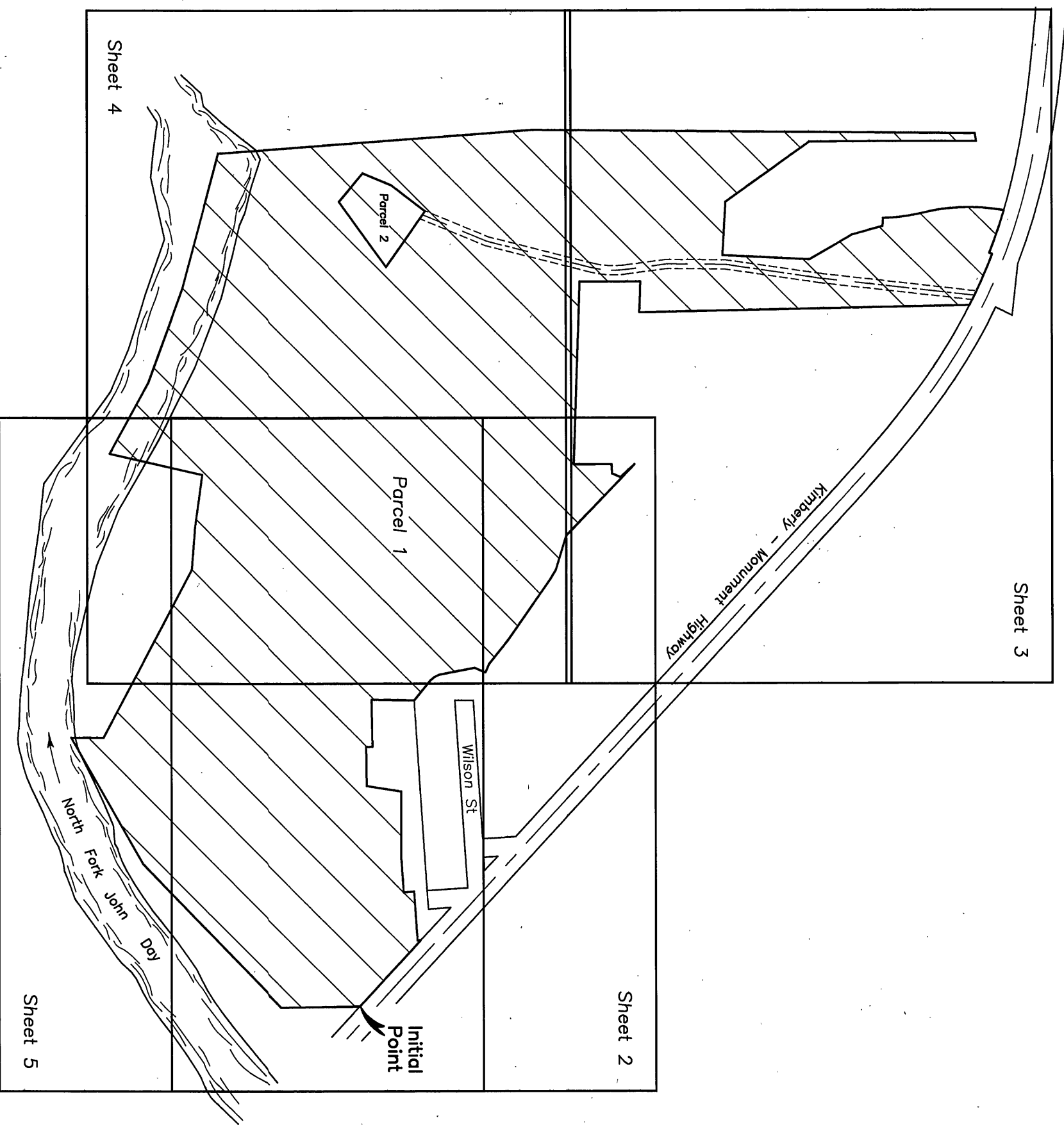

LAND PARTITION PLAT NO. 2021 02
 A PARTITION OF PARCEL 1, LAND PARTITION NO. 2000-16
 AND OTHER LANDS
 SITUATED IN THE SW1/4 AND THE NW1/4 SECTION 1
 TOWN OF MONUMENT
 GRANT COUNTY, OREGON
 May 12, 2021
 Sheet 1 of 7



Scale 1"=400'
 BASIS OF BEARINGS

Survey No. 2055
 Between found ODOT pin near Initial Point
 and the East corner of Parcel 3, LP 98-24

LEGEND

- Found 2 1/2" Grant County Surveyor brass cap monument.
- Found 5/8" iron pin with attached red plastic cap, unless otherwise shown.
- Found 5/8" iron pin with attached 2" alum. cap.
- Set 5/8" X 30" iron pin with attached red plastic cap marked CONKERNSTONE SURVEYING, INC.
- Found monument, see record map of survey number shown in box.
- () GLO record bearing and distance.
- () Survey No. 669 record bearing and distance.
- () Survey No. 1079 record bearing and distance.
- () Survey No. 1849 record bearing and distance.
- () Survey No. 1858 record bearing and distance.
- () Survey No. 2055 record bearing and distance.
- () Survey No. 2154 record bearing and distance.
- () Survey No. 2159 record bearing and distance.
- () Partition No. 96-02 record bearing and distance.
- () Partition No. 98-06 record bearing and distance.
- () Partition No. 98-24 record bearing and distance.
- () Partition No. 2000-16 record bearing and distance.
- () Partition No. 2009-11 record bearing and distance.
- () Deed Bk 92, Pg 448 record bearing and distance.
- () Deed Bk 49, Pg 191 record bearing and distance.
- () Inst. No. 931271 record bearing and distance.
- () Inst. No. 20211073 record bearing and distance.
- () Inst. No. 20082785 record bearing and distance.
- () Highway Drawing No. 68-20-5

REFERENCES

- Grant County Deed Records
- Book 49 Page 281
- Book 80 Page 116
- Book 92 Page 490
- Inst. No. 391271
- Inst. No. 351272
- Inst. No. 380039
- Inst. No. 382008
- Inst. No. 20211073
- Inst. No. 20082785
- Inst. No. 20091745
- Inst. No. 20211072
- Inst. No. 20211073
- Survey No. 1079
- Survey No. 1825
- Survey No. 1849
- Survey No. 1858
- Partition No. 98-06
- Partition No. 98-24
- Partition No. 2000-16
- Plat of Old Town of Monument Highway Drawing No. 68-20-5

REGISTERED
 PROFESSIONAL
 LAND SURVEYOR
 OREGON
 JACK WATSON
 2734
 Renewal Date 6/30/2022

SHEET INDEX
 Sheet 1 Vicinity Map and Narrative
 Sheet 2 Northeast portion of property boundary
 Sheet 3 Northwest portion of property boundary
 Sheet 4 Southwest portion of property boundary
 Sheet 5 Southeast portion of property boundary
 Sheet 6 Details A, B, C, D, E & F
 Sheet 7 Surveyor's Certificate, Declaration, Approvals

I do hereby certify that this is a true and exact copy of original Land Partition plat.
 Jack Watson, PLS

NARRATIVE
 This survey was performed at the request of Josh Hamilton. The purpose of this survey was to partition Mr. Hamilton's property as described in Instrument No.'s 20201551 and 20211073 into two parcels.
 A search was made of the available records pertaining to this survey. Field measurements were made to locate the existing monuments and the new corner positions. The boundaries of Parcel 2 were established as directed by Mr. Hamilton.
 I accept the found monuments as shown. The initial point was established on the north-south center line of Section 1 at the intersection with the Kimberly-Monument Highway south right of way line. I held the record Highway bearing and intersected the east line of the Hinton property as called for in the deed and describe in Deed Book 80, Page 116. Deed Book 92, Page 448 describes the boundary west of the Hinton property to be relative to the Old Town of Monument boundaries. I used the Old Town of Monument plat record distances to establish the boundary to the easterly monument shown on Survey No. 2159.
 The location of the Old Town of Monument, recorded in Book N, Page 585 of plats located in the office of the Grant County Clerk, has been determined and used for many years. The plat of the Old Town of Monument does not have any bearings shown. The plat of Jenk's Addition, recorded in Book 1, Page 13 in the Grant County Clerk's office, shows the relationship to the Old Town of Monument plat. I used the record bearings and distances shown on the Jenk's Addition plat to position the boundaries of the Old Town of Monument, which have been used for years.
 I accepted the found monuments from Survey No.'s 2159, 1849 and 1858. I used the record bearings shown on Survey No. 1858 and record bearing and distance from the found iron pipe called for in deed Book 49, Page 191, which is also shown on Survey No. 1858 to establish the two angle points on the north boundary. Then I accepted the found monuments from Land Partitions 98-24, 2009-11 and 96-02 and Survey No. 669. The monument at the NW corner of Survey No. 669 was missing. I attempted to set the pin which ruptured an 8" buried irrigation line. The monument was not established. I considered the found monuments south and east to be close enough to be used as references to the corner position. I established the corner which is 100 feet easterly on line between the found monuments of Survey No. 669 and at record distance from the NW corner of that survey.
 I found the monument at the NE corner of Parcel 2 of Partition No. 98-24. I held the found monument and used the plat record along the southerly highway right of way line to re-set the missing monument at the NW corner of said Parcel 2. I used the highway record bearings and distances given in Deed Book 49, Page 281 and shown on Highway Drawing No. 68-20-5, to position the two monuments at Highway Station 706+00 on the south right of way line.
 I accepted the found monuments on the easterly boundary of Land Partition No. 98-06 and replace the two missing monuments at record bearing and distance from the found pins. I accepted the found monuments from Survey No. 1079 and the found pin from Land Partition No. 2000-16 as shown. I established a monument at the intersection of the west line of Section 1 and the south line of Parcel 2 of Land Partition No. 2000-16.
 The west boundary of this partition is along the west line of Section 1 which is shown on Survey No. 2154 to the intersection with the centerline of the North Fork of the John Doy River.
 Deed Instrument No. 931271 is a deed from Jack Covender to the BLM. This document states that 1/2"x24" iron pins were established on the boundary. No survey map was recorded but I did find several of the pins that were called for. They had plastic caps marked "P.S. 761 290 WRE". I accepted these found monuments and rotated the record bearings counterclockwise 00°04'00" along the northwesterly boundary of the deed and used the record distance to position the last pin on the east boundary of Instrument No. 931271. I held the record bearings and distances given in deed Book 92, Page 448. Exception #2 to establish the remainder of the south boundary. I intersected the north-south centerline of Section 1 as shown on Survey No. 2154 and the record call at 842.42 feet from the C1/4 corner of Section 1 to establish the SE corner of this partition boundary.